



About Us

Accel Infratech India Pvt. Ltd. is a leading supplier of construction equipments since 2019. We are committed to provide high end construction equipments to our clients by combining technology with quality. We ensure the safety of our customers through dedicated maintenance work to ensure long lasting relationship through certified engineers.

We believe in providing an ideal work environment for our workers and technicians who are engaged in production of construction equipments.

We are exporting to more than 30 countries Worldwide including Kenya, Tanzania, Romania, Ghana, Zambia, Bangladesh, Nepal, Bhutan and many more.



We Believe in Quality Services

Accel Infratech India Pvt. Ltd. is a leader in construction equipments. With over 10+ years of experience as supplier and servicing of equipment for the Construction Industry by our team members, we today offer almost the entire range of machineries and services. Our quality standards help our customers to smoothly deliver their commitment of time and quality for making roads & buildings of International standard, day by day our innovative approach provides automation excellence in construction machinery. Customer satisfaction is our first importance and our motive.



Asphalt Drum Mix Plant

Asphalt plant is also known as Asphalt Drum Mix Plant, Hot Mix Plant, continuous Asphalt type plant, parallel flow type etc. Asphalt plant works on the principal of mixing aggregate with bitumen/asphalt at certain temperature to give a proper mix for paving. Accel Infratech India is a leading construction company dealing in other Asphalt Plants as well including Asphalt Batch Mix Plant & Mobile Hot Mix Plant.

The range of Asphalt Drum Mix Plant Start from 15 TPH to 120 TPH, available in both mobile and stationery models.

An Asphalt Drum Mix Plant plant is an intelligent assembly of mechanical and electronic equipment where aggregates & minerals are blended, dried, heated, and mixed with asphalt to produce hot mix asphalt (HMA) meeting specified requirements of road building. The Plant is made up of high quality steel & rugged design to give high performance for long time without compromising on the quality of produce/mix with high fuel efficiency Hence enchasing the profit earning of the customers.

Accel Infratech India is one step solution for all your needs if you are looking for a company dealing in road and building construction equipment. Apart from supplying the Asphalt Plants, we also provide other related services to our clients including after sales support, regular maintenance, spare part support etc.

The Asphalt Drum Mix Plant Consists of:

Cold Aggregate Four-Bin Feeder
Single Deck Vibratory Screen for oversized material removal
Slinger (Cold) Conveyor
Dryer Auto Burner
Drying Cum Mixing Thermo drum with Dust Collector
Load out conveyor with Gob hopper
Asphalt Tank
Mineral Filler Unit
Centralized Control Panel with insulated Cabin
Fuel Storage Tank

MODEL	CAPACITY
DM-15	15 TO 20 TPH
DM-20	20 TO 30 TPH
DM-40	40 TO 60 TPH
DM-50	60 TO 90 TPH
DM-60	90 TO 120 TPH

ASPHALT DRUM MIX PLANT

TECHNICAL SPECIFICATION

MODEL	DM-15	DM-20	DM-40	DM-50	DM-60
CAPACITY RANGE (TPH)*	15 to 20	20 to 30	40 to 60	60 to 90	90 to 120
DRYER					
Length (m)	5	6.2	6.2	6.75	6.75
Diameter (m)	1.05	1.13	1.22	1.5	1.82
Insulation (Cerawool in mm)	25	25	25	25	25
Exhauster (CFM)	5500	7500	10500	14500	18500
Burner Rating (Ltrs./Hr.)	150	150	250	350	550
BIN FEEDER					
No. of Bins	4	4	4	4	4
Bin Capacity (MT)	8	8	11	11	13
Belt Feeder Width (mm)	500	500	500	500	500
Gathering Conveyor Width (mm)	600	600	600	600	600
SLINGER CONVEYOR					
Conveyor Width (mm)	600	600	600	600	600
LOADOUT CONVEYOR					
Conveyor Width (mm)	600	600	600	600	600
Loadout Height (m)	3.2	3.2	3.2	3.2	3.2
Hopper Capacity (kg)	800	800	800	1000	1000
POWER REQUIREMENTS					
Drum Drive (HP)	10	15	20	30	40
Exhauster (HP)	10	15	20	25	50
Bin Feeder Hopper (HP)	4 x 2	4 x 2	4 x 2	4 x 2	4 x 3
Gathering Conveyor (HP)	3	5	5	5	7.5
Slinger Conveyor (HP)	3	5	5	5	7.5
Vibratory Screen (HP)	1	1	1	1	2
Loadout Conveyor (HP)	3	5	5	5	7.5
Hydraulic Powerpack (HP)	2	2	2	2	5
Bitumen (Asphalt) Pump (HP)	3	3	3	3	3
Filler Unit					
Rotary valve (HP)	1.5	1.5	2	2	5
Blower (HP)	5	5	5	5	5
Dryer Automatic Burner					
Fuel Pump (HP)	2	2	2	2	3
Blower (HP)	3	3	5	10	15
Hot Oil Pump (HP)	0.5	0.5	0.5	0.5	0.5
BITUMEN TANK					
Capacity (MT)	15	15	15	20	20
Insulation (Glasswool in mm)	50	50	50	50	50
FUEL TANK					
Capacity (Ltrs.)	2500	2500	5000	5000	5000
TOTAL CONNECTED LOAD					
Load (KVA)	80	100	120	135	220

*Capacity@3% moisture content

Due to ACCEL Policy of continuous improvement / development, the technical data mentioned in this entire sheet is not binding and subject to change without notice.

Components of Drum Mix Plant



Four Bin Feeder



Dryer Drum



Control Panel



Dryer Burner



Vibratory Screen



Asphalt (Bitumen) Tank



Bitumen Burner



Filler Unit



Fuel Tank



Flight Design Inside Dryer Drum



Mobile Four Bin Feeder



Mobile Dryer
With Multicyclone & Exhauster



Mobile Dryer Drum



Hot Mix Storage Silo



Bag House Filter

Certain components shown here are optional.
Please refer our offer to know the exact scope of supply.

Layout of Drum Mix Plant

General Layout of Drum Mix Plant

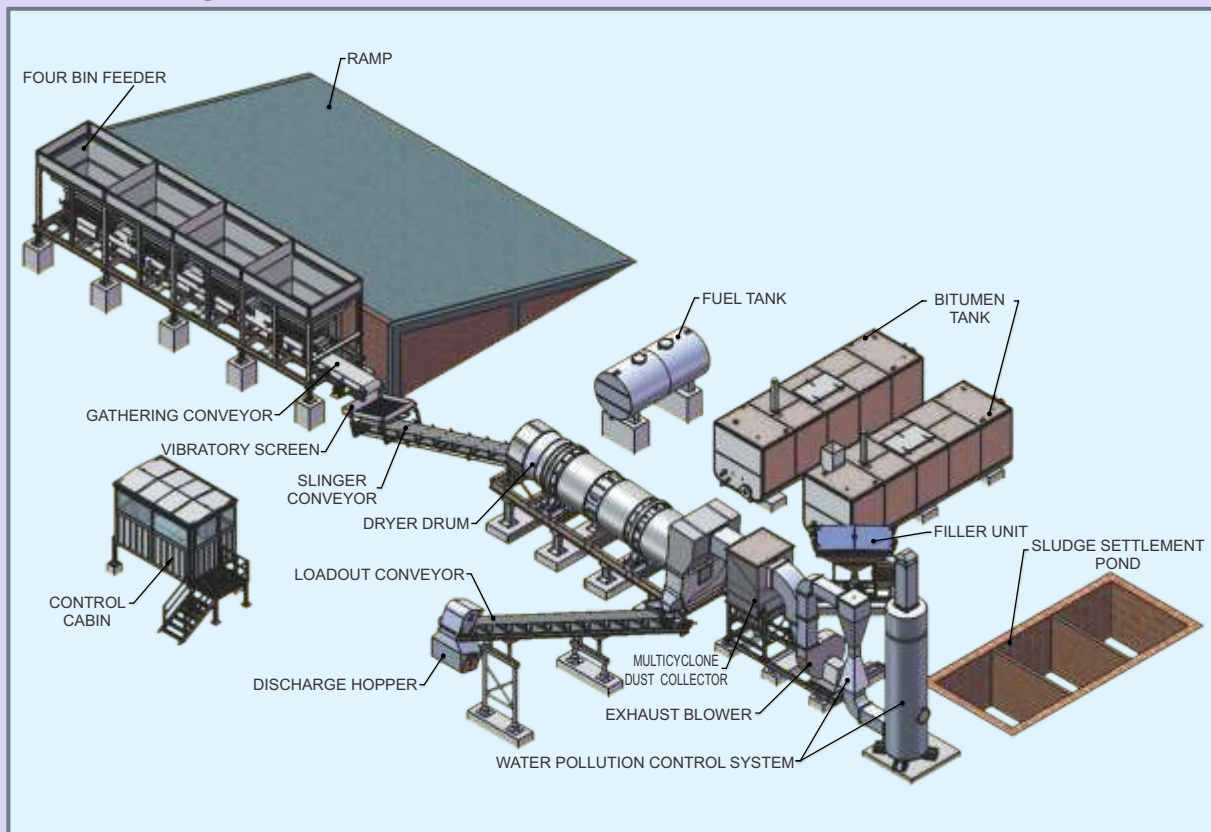

Land area requirement for installation - 40 mtr. x 40 mtr. (max.)

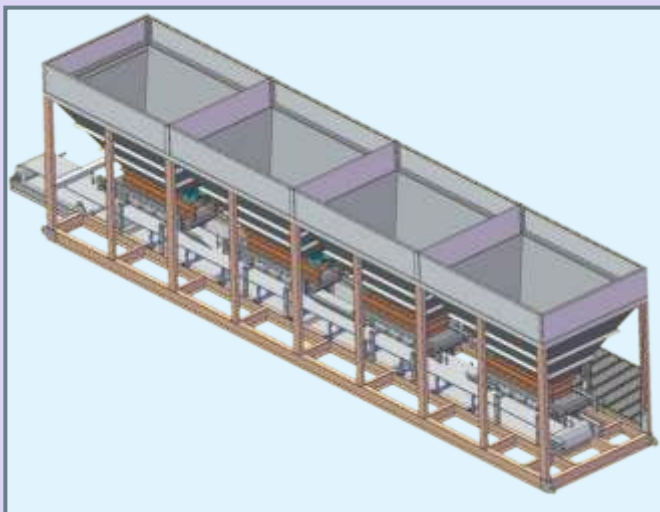

Stationary Four Bin Feeder

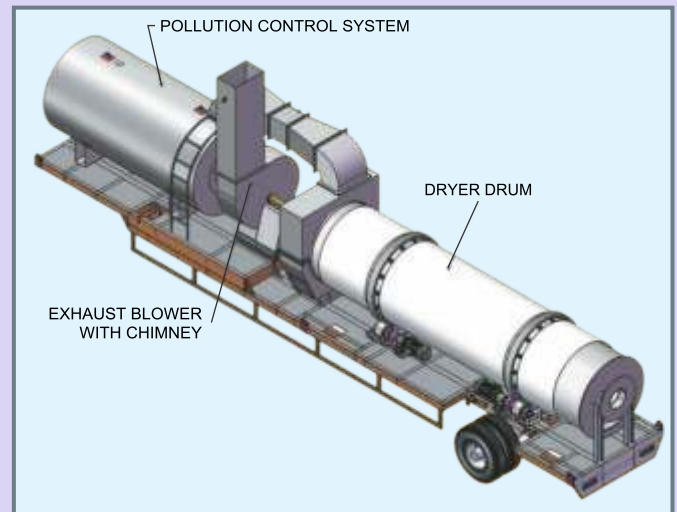

Mobile Dryer Drum with Wet Type Pollution Control System on same Chassis

Sensor Paver Finisher



Technical Specifications: WSP 550 (Suitable for Bituminous, Wet Mix, GSB, DLC & DBM Materials)

TRACTOR			FEEDERS	
Operating Height	3.43 m		Auger	Highly wear resisting steel casting dia. 355 mm 20 mm thickness
Shipping Height	2.52 m		Feed Tunnel Width	590 mm
Height w/o Canopy	2.52 m		Conveyor Floor Plate	Wear resisting steel 12 mm
Lenght	6.61 m		Feed Control System	2 nos. on/off Type
Operating Width	3.14 m		Auger Control System	2 nos. on/off Type
Shipping Width	2.54 m		Auger Lowest Position From Ground	150 mm
Tread Width	2.08 m		Auger and Conveyor Drive	Synchronised
Truck Dumping Clearance	0.48 m		SCREED TV 4500	
Wheel Base	2.61 m		Screed Basic Width	2.50 m
Frame Plate Thickness	16 mm		Infinite Variable Extension	2.50 m to 4.50 m
PRIME MOVER			With Bolt On Extension Max	5.75 m
Engine Make	Kirloskar	Ashok Leyland	Screed Weight Main	2890 kg
Model No.	6R1080TA1	H6ETIC3RU23	Bolt On Extension Weight	210 kg (625 mm)
Engine Power	92 kW @ 2300 rpm	99 kW @ 2300 rpm	Crown	-1 to +4.5%
Electrical System	12 VDC		Gradient Slope	10 % Gradient Slope
Type of Cooling	Water Cooled		Screed Vibration	30 - 50 Hz
WHEELS			Tamping	18 - 27 Hz (5 mm)
Tyre Front Solid	4 nos. / 22 x 16 x 12		Screed Plate	320 mm x 12 mm Wear Resistant
Tyre Rear Pneumatic	4 nos. / 10.00 x 20		Screed Heaters	4 nos. Diesel (Propane Optional)
PERFORMANCE			Foot Rest	-
Weight	14840 kg		SENSOR DEVICE	
Turning Radius Inner	5.5 m		Grade and Slope Control	Moba Controls
Laying Capacity	300 TPH		Power Output	on/off Type
Paving Thickness	10 - 300 mm		Grade control measuring range	(±) 70 mm
Paving Speed	0 - 40 m/min		Obtainable accuracy for grade	(±) 1 mm
Travel Speed (Second)	0 - 15 Km/hr		Slope control measuring range	(±) 10 %
Hopper Capacity (Approx.)	10 t		Obtainable accuracy for slope	(±) 0.05 %
CAPACITY			Enclosure Protection	IP54
Fuel Tank Capacity	132 Ltr.		Safety Devices	In built pressure relief valves
Hydraulic Tank Capacity	190 Ltr.		Make / Type Of Pumps And Motors	Sauer Danfoss or Equivalent
CONTROLS				
Operating Station	Dual Station			
Brake	Kaliper Disk Brake			

Mechanical Paver Finisher



Technical Specifications: WAP 450 & WWP 450 (Suitable for Bituminous, Wet Mix, GSB, DLC & DMB Materials)

MODEL	WAP 450 HES (DUAL APPLICABLE)	WWP 450 HES (DUAL APPLICABLE)	
Operating Height	3.05 m	3.05 m	
Shipping Height	2.43 m	2.43 m	
Length	5.8 m	5.8 m	
Operating Width	3.12 m	3.12 m	
Shipping Width	2.7 m	2.7 m	
Truck Dumping Clearance	0.6 m	0.6 m	
Wheel Base	2.5 m	2.5 m	
Engine Make	Kirloskar	Kirloskar	Ashok Layland
Engine Model No.	4R 1040	4R 1040T	ALU 6.65
Engine Power	76 HP @ 2200 rpm	105 HP @ 2200 rpm	105 HP @ 2200 rpm
Electrical System	12 VDC	12 VDC	
Weight (Approx.)	9.5 t	10 t	
Hopper Capacity (Approx.)	4 Cubic Meter	4 Cubic Meter	
Steering	Power Steering	Power Steering	
Travel Speed	0 - 16 km/hr	0 - 16 km/hr	
Paving Thickness	10 - 200 mm	10 - 200 mm	
Paving Speed	1.25 - 23 m	1.25 - 23 m	
Paving Width	2.5 - 4.5 m	2.5 - 4.5 m	
Tyre Front Solid	2 nos. / 22 x 16 x 12	2 nos. / 22 x 16 x 12	
Tyre Rear Pneumatic	2 nos. / 11 x 20 - 18 PLY	2 nos. / 12 x 20 - 18 PLY	
Fuel Tank Capacity	120 Ltr.	120 Ltr.	
Hydraulic Tank Capacity	80 Ltr.	80 Ltr.	
Auger Diameter	300 mm	300 mm	
Screed Type	Hydraulically Extendable	Hydraulically Extendable	
Screed Vibration	0 to 2000 Per Minute	0 to 2000 Per Minute	
Crown	-1 to +3 %	-1 to +3 %	

Key Features of Paver Finisher

KEY FEATURES

Powered with Kirloskar /AshokLeyland Engine

Hydraulic Cylinder Tafe / Dental

Steering Unit Sauer Danfoss

Auger Diameter - 300 mm (Ni - hard material)

Screed Plate of S.S / Hardox 400

Tyre CEAT / Apollo

Battery Exide / Prestolite

BRIEF DESCRIPTION

SR. NO	MODEL	ENGINE	PAVING WIDTH	SCREED
01	WSP - 550	Kirloskar 6R1080TA1 125 HP/ ASHOK LEYLAND 125 HP	2.5 to 4.5 m Dual Applicable (Upto 5.75 m With Extension)	Hydraulically Extendable Temping & Vibrating Screed
02	WWP - 450 (HES)	Kirloskar TURBO 105 HP/ ASHOK LEYLAND 101 HP	2.5 to 4.5 m Dual Applicable (Upto 5 m With Extension)	Hydraulically Extendable Vibratory Screed
03	WAP - 450 (HES)	Kirloskar 76 HP	2.5 to 4.5 m (Upto 5 m With Extension)	Hydraulically Extendable Vibratory Screed
04	WWP - 450 (STD.)	Kirloskar TURBO 105 HP/ ASHOK LEYLAND 101 HP	2.5 to 4.5 m Dual Applicable	Mechanical Screed (Bolted Extension From 75 mm to 300 mm)

Static Diesel Road Roller



We are the Authorised distributor for Britannia make Static Diesel Road Rollers. Manufactured by Britannia Engineering Limited in Kolkata the product does not require an introduction as it is famous by the name of BM Road Roller Countrywide. With the capacity of 8 - 10 Tons powered by a 41.5 BHP Simpsons S4 Diesel Engine the roller provides ultimate compaction ability thus giving our customers a smooth finish of the roads.



Mobile Hot Mix Plant



Our company is a leading manufacturer, supplier and exporter of heavy duty Diesel Engine Mobile Hot Mix plant which is especially designed to produce large volume of rich black asphalt used in the construction of roads and highways. It is provided with a high speed and high temperature mixing unit which is fixed with an inlet hopper to feed materials to the processing chamber. The structural frame of this machine unit is fabricated by using premium class engineering materials which imparts greater strength and rigidity. It is powered by a 20 H.P. Diesel Engine.

Benefits:

- Easy to Move / Transport
- Compact Design
- Easy to Use
- Higher output per Batch
- Cost Effective



Trolley Mounted Sprayers

Emulsion Sprayer

Emulsion sprayer is a heavy road construction equipment which is used for the spraying of chemicals over the road surfaces during construction. It is provided with a large storage tank with a volumetric capacity of 1000 litres mounted on a rigid frame fixed with wheels to easily move this unit to different site locations. It is also provided with a high pressure rotary gear pump for spraying of the liquid with the help of a nozzle.

"ACCEL" (AES-1000) Cationic (Cold Emulsion) Sprayer, Capacity 1000 litres, with Rotary Gear Pump and Spraying arrangement (flexible pipe with nozzle and spray gun), fitted with 6 HP Air Cooled Diesel Engine. The whole unit is mounted on Steel Chassis with 4 Nos. Pneumatic Tyre wheels with draw bar arrangement.



Bitumen Sprayer



Bitumen Sprayer, which is manufactured under the stringent surveillance of our skilled professionals. It is available in 2000 / 2500 & 3000 ltrs capacity, and is fitted with pan built from MS Plate. There is space between the outer and inner Pan which is packed with glass wool covered with MS Sheet, mounted on manufactured chassis with tyre wheels. This Hot Bitumen Sprayer is powered by adequate rated Air-cooled Diesel Engine. Oil Burner & Blowers, Oil Tanks, Outlet and Inlet Valves, Gear Pump with special type Spray Bar and handle are provided.

Hydraulic Road Sweeper

"ACCEL" Hydraulic Road Sweeper with Dust collecting system, Model : RS-2100 (Without Tractor) has a sweeping width of 2.10 Meters. These Road Sweeper are Equipped with PPN Bristles for efficient and durable cleaning of the Road. This Sweeper Machine is Preferred by a Lot of Road Contractors for its Ease of Operation. It can be Conveniently Moved by Attaching at the Rear of Tractor. Operation and Maintenance of Sweeper is Easy and does not require Skilled Labor.

Salient Features:

- Dust Collection Bin Available
- Quick Mounting with Tractor
- Three Point Linkage System
- Compact and Flexible Design
- Easy to Operate and Maintain
- Low Noise and High Performance
- Maintenance free Hydraulic Drive



Application:

It is mainly used as commercial Applications for Sweeping the dust and debris on the Road, Streets, Highways, Industrial Floors, Petrol Pumps, Glass Factories, Sea & Air Ports, Cement Industries, Schools etc.

Optionals:

- **Water Sprinkling System**
- **Side Brush System**

Other Products



WET MIX MACADAM PLANT



CONCRETE BATCHING PLANT



MINI VIBRATORY ROLLER



ROAD MARKING MACHINE



BITUMEN



CRASH BARRIERS

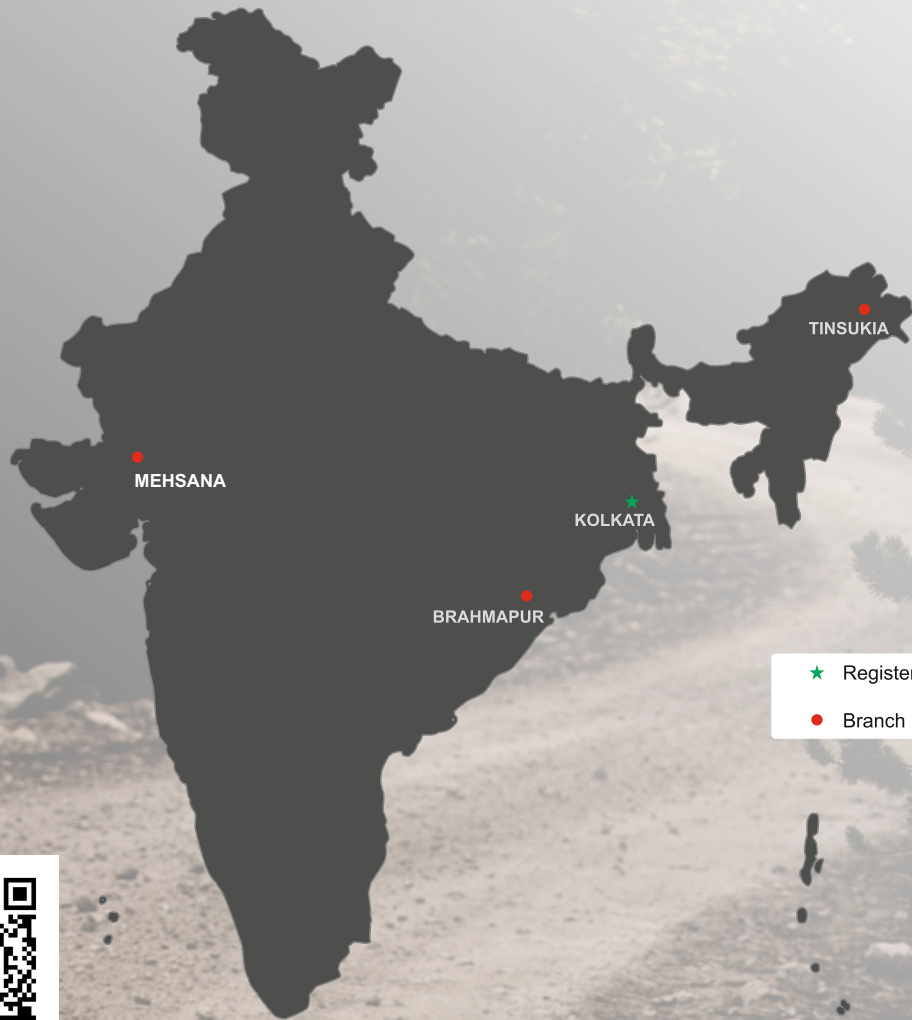

Registered Office:

Accel Infratech India Private Limited
9A, Judges Court Road, Pearl Court, 5th Floor, Suite No. 5A / 5C
5th Floor, Kolkata - 700027, West Bengal, India.
Tel: +91 9088224466 / 9435008001
Email: info@accelinfra.com
Website: www.accelinfra.com

Branch Offices:

Assam

Rasiwasia Nagar, Makum Road, Near Mandhanian Bhawan
Tinsukia - 786146, Assam, India.

Odisha

Aska Road, Near H.P. Petrol Pump, Dist: Ganjam
Brahmapur - 760001, Odisha, India.